



Plunger Endura



DATA SHEET

Dimensional parameters

01 Endura B-RS: with Ring and Spring Bush

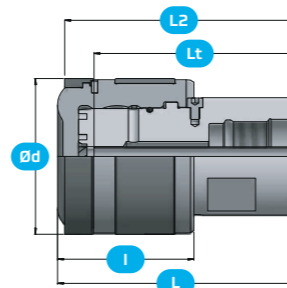

REFERENCE

TYPE	HOLDER	D	VAC	RING WIDTH	PLUNGER	RING	SPRING BUSH	HOLDER	PRESSURE RING
Endura B-RS	1.0	45	Vac	short	KDURS01004501471	RIUS004503701671	DRUF045039025201	TDUF010025100251	TGUZ04503517
Endura B-RS	1.5	50	Vac	short	KDURS01505001471	RIUS005004201671	DRUF050044025201	TDUF015030110301	TGUZ05003517
Endura B-RS	1.5	55	Vac	short	KDURS01505501471	RIUS005504201671	DRUF055049025201	TDUF015030110301	TGUZ05003517
Endura B-RS	2.5	60	Vac	short	KDURS02506001471	RIUS006004501671	DRUF060054 03020 1	TDUF025040100301	
Endura B-RS	2.5	65	Vac	short	KDURS02506501471	RIUS006504201671	DRUF065059030201	TDUF025040100301	
Endura B-RS	2.5	70	Vac	short	KDURS02507001471	RIUS007005001671	DRUF070064030201	TDUF025040100301	
Endura B-RS	3.0	75	Vac	short	KDURS03007501471	RIUS007505501671	DRUF075069040201	TDUF030045110351	
Endura B-RS	3.0	80	Vac	short	KDURS03008001471	RIUS008005501671	DRUF080074040201	TDUF030045110351	
Endura B-RS	3.5	85	Vac	short	KDURS03508501471	RIUS008505501671	DRUF085079040201	TDUF035055110351	
Endura B-RS	3.5	90	Vac	short	KDURS03509001471	RIUS009006501671	DRUF090084040201	TDUF035055110351	
Endura B-RS	3.5	95	Vac	short	KDURS03509501471	RIUS009506501671	DRUF095089040201	TDUF035055110351	
Endura B-RS	4.0	100	Vac	short	KDURS04010001471	RIUS010006501671	DRUF100092050201	TDUF040064100421	
Endura B-RS	4.0	105	Vac	short	KDURS04010501471	RIUS010506501671	DRUF105097050201	TDUF040064100421	
Endura B-RS	4.0	110	Vac	short	KDURS04011001471	RIUS011006501671	DRUF110102050201	TDUF040064100421	
Endura B-RS	4.2	100	Vac	short	KDURS04210001471	RIUS010006501671	DRUF100092050201	TDUF042070100481	
Endura B-RS	4.2	105	Vac	short	KDURS04210501471	RIUS010506501671	DRUF105097050201	TDUF042070100481	
Endura B-RS	4.2	110	Vac	short	KDURS04211001471	RIUS011006501671	DRUF110102050201	TDUF042070100481	
Endura B-RS	4.2	115	Vac	short	KDURS04211501471	RIUS011507001671	DRUF115107050201	TDUF042070100481	
Endura B-RS	4.2	120	Vac	short	KDURS04212001471	RIUS012007501671	DRUF120112050201	TDUF042070100481	
Endura B-RS	4.2	125	Vac	short	KDURS04212501471	RIUS012507501671	DRUF125117050201	TDUF042070100481	
Endura B-RS	4.2	130	Vac	short	KDURS04213001471	RIUS013007501671	DRUF130122050201	TDUF042070100481	
Endura B-RS	4.5	115	Vac	short	KDURS04511501471	RIUS011507001671	DRUF115107050201	TDUF045080100601	
Endura B-RS	4.5	120	Vac	short	KDURS04512001471	RIUS012007501671	DRUF120112050201	TDUF045080100601	
Endura B-RS	4.5	125	Vac	short	KDURS04512501471	RIUS012507501671	DRUF125117050201	TDUF045080100601	
Endura B-RS	4.5	130	Vac	short	KDURS04513001471	RIUS013007501671	DRUF130122050201	TDUF045080100601	
Endura B-RS	5.0	135	Vac	short	KDURS05013501471	RIUS013507501671	DRUF135125050201	TDUF050090100601	
Endura B-RS	5.0	140	Vac	short	KDURS05014001471	RIUS014007501671	DRUF140130050201	TDUF050090100601	
Endura B-RS	6.0	150	Vac	short	KDURS06015001471	RIUS015008501671	DRUF150140050201	TDUF060100110651	
Endura B-RS	6.0	160	Vac	short	KDURS06016001471	RIUS016008501671	DRUF160150050201	TDUF060100110651	
Endura B-RS	7.0	170	Vac	short	KDURS07017001471	RIUS017010001671	DRUF170158090201	TDUF070120100721	
Endura B-RS	7.0	180	Vac	short	KDURS07018001471	RIUS018010002671	DRUF180168090201	TDUF070120100721	
Endura B-RS	8.0	190	Vac	short	KDURS08019001471	RIUS019010001671	DRUF190178090201	TDUF080130100721	
Endura B-RS	8.0	200	Vac	short	KDURS08020001471	RIUS020011001671	DRUF200188090201	TDUF080130100721	
Endura B-RS	9.0	210	Vac	short	KDURS09021001471	RIUS021010001671	DRUF210198090201	TBUF090145100851	
Endura B-RS	9.0	220	Vac	short	KDURS09022001471	RIUS022010001671	DRUF220208090201	TBUF090145100851	
Endura B-RS	10.0	230	Vac	short	KDURS10023001471	RIUS023010001671	DRUF230216100201	TBUF100160101001	
Endura B-RS	10.0	240	Vac	short	KDURS10024001471	RIUS024010001671	DRUF240226100201	TBUF100160101001	
Endura B-RS	11.0	250	Vac	short	KDURS11025001471	RIUS025011001671	DRUF250236110201	TBUF110170101201	
Endura B-RS	11.0	260	Vac	short	KDURS11026001471	RIUS026011001671	DRUF260246110201	TBUF110170101201	

Plunger ENDURA

DIMENSION

TYPE	PLUNGER L	PLUNGER T x a	PLUNGER M x B	PLUNGER Lt (Tube) -2mm	PLUNGER Qt (Tube)	RING	SPRING BUSH	HOLDER	SYSTEM LENGTH L2	SYSTEM LENGTH total
Endura B-RS	60			105	6	045/37,5 x 14	045/39 x 25	042 x 111	116.00	118
Endura B-RS				109	8	050/41,5 x 16	050/44 x 25	048 x 115	121.00	123
Endura B-RS				109	8	055/46,5 x 16	055/49 x 25	048 x 115	121.00	123
Endura B-RS				116	10	060/51 x 17	060/54 x 30	058 x 123	128.00	131
Endura B-RS				116	10	065/56 x 17	065/59 x 30	058 x 123	128.00	131
Endura B-RS				116	12	070/60 x 17	070/64 x 30	058 x 123	128.00	131
Endura B-RS				136	12	075/64 x 17,5	075/69 x 40	070 x 144	149.00	153
Endura B-RS				136	12	080/69 x 17,5	080/74 x 40	070 x 144	149.00	153
Endura B-RS				136	12	085/74 x 17,5	085/79 x 40	079 x 143	149.00	153
Endura B-RS				136	12	090/77 x 18,5	090/84 x 40	079 x 143	149.00	153
Endura B-RS				136	12	095/82 x 18,5	095/89 x 40	079 x 143	149.00	153
Endura B-RS				120	16	0100/87 x 20	0100/92 x 50	079 x 129	137.00	141
Endura B-RS				120	16	0105/92 x 20	0105/97 x 50	079 x 129	137.00	141
Endura B-RS				120	16	0110/97 x 20	0110/102 x 50	079 x 129	137.00	141
Endura B-RS				120	16	0100/87 x 20	0100/92 x 50	089 x 128	137.00	141
Endura B-RS				120	16	0105/92 x 20	0105/97 x 50	089 x 128	137.00	141
Endura B-RS				120	16	0110/97 x 20	0110/102 x 50	089 x 128	137.00	141
Endura B-RS				120	16	0115/101 x 22	0115/107 x 50	089 x 128	137.00	141
Endura B-RS				120	16	0120/105 x 22	0120/112 x 50	089 x 128	137.00	141
Endura B-RS				120	16	0125/110 x 22	0125/117 x 50	089 x 128	137.00	141
Endura B-RS				120	16	0130/115 x 24	0130/122 x 50	089 x 128	137.00	141
Endura B-RS				170	16	0115/101 x 22	0115/107 x 50	098 x 179	189.00	193
Endura B-RS				170	16	0120/105 x 22	0120/112 x 50	098 x 179	189.00	193
Endura B-RS				170	16	0125/110 x 22	0125/117 x 50	098 x 179	189.00	193
Endura B-RS				170	16	0130/115 x 24	0130/122 x 50	098 x 179	189.00	193
Endura B-RS				169	16	0135/120 x 24	0135/125 x 50	0108 x 179	189.00	195
Endura B-RS				169	16	0140/125 x 24	0140/130 x 50	0108 x 179	189.00	195
Endura B-RS				166	18	0150/133 x 26	0150/140 x 50	0125 x 178	188.00	194
Endura B-RS				166	18	0160/143 x 28	0160/150 x 50	0125 x 178	188.00	194
Endura B-RS				200	20	0170/150 x 30	0170/158 x 90	0145 x 214	227.00	233
Endura B-RS				200	20	0180/160 x 32	0180/168 x 90	0145 x 214	227.00	233
Endura B-RS				215	20	0190/168 x 32	0190/178 x 90	0155 x 229	243.00	249
Endura B-RS				215	20	0200/180 x 32	0200/188 x 90	0155 x 229	243.00	249
Endura B-RS	185			245	25	0210/190 x 32	0210/198 x 90	0185 x 262	278.00	284
Endura B-RS	185			245	25	0220/200 x	0220/208 x 90	0+T29+T123-T1+T130-T164	278.00	284
Endura B-RS				245	25	0230/210 x 33	0230/216 x 100	0200 x 260	278.00	284
Endura B-RS				245	25	0240/220 x 33	0240/226 x 100	0200 x 260	278.00	284
Endura B-RS				265	30	0250/228 x 35	0250/236 x 110	0220 x 284	304.00	310
Endura B-RS				265	30	0260/238 x 35	0260/246 x 110	0220 x 284	304.00	310

Dimensional parameters

02 Endura T: without Ring

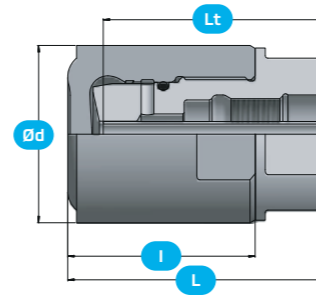

REFERENCE

TYPE	HOLDER	D	VAC	RING WIDTH	PLUNGER	RING	SPRING BUSH	HOLDER	PRESSURE RING
Endura T	1.5	50		short	KTUF001505001471			TAUF01530100501	
Endura T	1.5	55		short	KTUF001505501471			TAUF01530100551	
Endura T	2.5	60		short	KTUF002506001471			TAUF02540100601	
Endura T	2.5	65		short	KTUF002506501471			TAUF02540100651	
Endura T	2.5	70		short	KTUF002507001471			TAUF02540100701	
Endura T	3.2	75		short	KTUF003207501471			TAUF03246100751	
Endura T	3.2	80		short	KTUF003208001471			TAUF03246100801	
Endura T	3.2	85		short	KTUF003208501471			TAUF03246100851	
Endura T	3.2	90		short	KTUF003209001471			TAUF03246100901	
Endura T	4.0	95		short	KTUF004009501471			TAUF04065100951	
Endura T	4.0	100		short	KTUF004010001471			TAUF04065101001	

DIMENSION

TYPE	PLUNGER L	PLUNGER T x a	PLUNGER M x B	PLUNGER Lt (Tube) -2mm	PLUNGER Qt Tube)	RING	SPRING BUSH	HOLDER	SYSTEM LENGTH L2	SYSTEM LENGTH total
Endura T	63			79	10			Ø49 x 81	87.00	90
Endura T	63			79	10			Ø54 x 81	87.00	90
Endura T	74			88	10			Ø58 x 91	98.00	101
Endura T	74			88	10			Ø63 x 91	98.00	101
Endura T	74			88	10			Ø68 x 91	98.00	101
Endura T	85			102	12			Ø73 x 105	113.00	117
Endura T	85			102	12			Ø78 x 105	113.00	117
Endura T	85			102	12			Ø83 x 105	113.00	117
Endura T	85			102	12			Ø88 x 105	113.00	117
Endura T	97			112	16			Ø93 x 115	125.00	129
Endura T	97			112	16			Ø98 x 115	125.00	129

Dimensional parameters

03 Endura T-R: with Ring

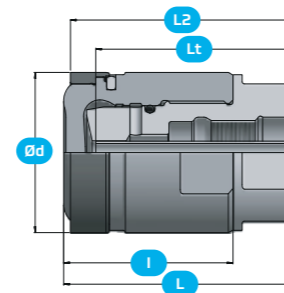

REFERENCE

10.343 mm	HOLDER	D	VAC	RING WIDTH	PLUNGER	RING	SPRING BUSH	HOLDER	PRESSURE RING
Endura T-R	1.5	50		short	KTUR001505001471	RIUS005004201671		TAUF01530100501	
Endura T-R	1.5	55		short	KTUR001505501471	RIUS005504201671		TAUF01530100551	
Endura T-R	2.5	60		short	KTUR002506001471	RIUS006004501671		TAUF02540100601	
Endura T-R	2.5	65		short	KTUR002506501471	RIUS006505501671		TAUF02540100651	
Endura T-R	2.5	70		short	KTUR002507001471	RIUS007005501671		TAUF02540100701	
Endura T-R	3.2	75		short	KTUR003207501471	RIUS007505501671		TAUF03246100751	
Endura T-R	3.2	80		short	KTUR003208001471	RIUS008005501671		TAUF03246100801	
Endura T-R	3.2	85		short	KTUR003208501471	RIUS008506501671		TAUF03246100851	
Endura T-R	3.2	90		short	KTUR003209001471	RIUS009006501671		TAUF03246100901	
Endura T-R	4.0	95		short	KTUR004009501471	RIUS009506501671		TAUF04065100951	
Endura T-R	4.0	100		short	KTUR004010001471	RIUS010006501671		TAUF04065101001	

DIMENSION

TYPE	PLUNGER L	PLUNGER T x a	PLUNGER M x B	PLUNGER Lt (Tube) -2mm	PLUNGER Qt Tube)	RING	SPRING BUSH	HOLDER	SYSTEM LENGTH L2	SYSTEM LENGTH total
Endura T-R	63			79	10	Ø50/41,5 x 16		Ø49 x 81	87.00	90
Endura T-R	63			79	10	Ø55/46,5 x 16		Ø54 x 81	87.00	90
Endura T-R	74			88	10	Ø60/51 x 17		Ø58 x 91	98.00	101
Endura T-R	74			88	10	Ø65/56 x 17		Ø63 x 91	98.00	101
Endura T-R	74			88	10	Ø70/60 x 17		Ø68 x 91	98.00	101
Endura T-R	85			102	12	Ø75/64 x 17,5		Ø73 x 105	113.00	117
Endura T-R	85			102	12	Ø80/69 x 17,5		Ø78 x 105	113.00	117
Endura T-R	85			102	12	Ø85/74 x 17,5		Ø83 x 105	113.00	117
Endura T-R	85			102	12	Ø90/77 x 18,5		Ø88 x 105	113.00	117
Endura T-R	97			112	16	Ø95/82 x 18,5		Ø93 x 115	125.00	129
Endura T-R	97			112	16	Ø100/87 x 20		Ø98 x 115	125.00	129

Dimensional parameters

04 Endura T-RS: with Ring and Spring Bush

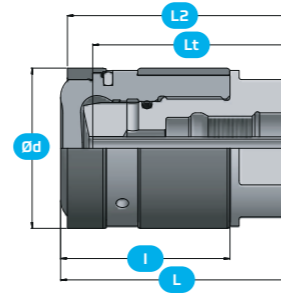

REFERENCE

TYPE	HOLDER	D	VAC	RING WIDTH	PLUNGER	RING	SPRING BUSH	HOLDER	PRESSURE RING
Endura T-RS	1.5	50	Vac	short	KTURS01505001471	RIUS005004201671	DRUF050044030201	TAUF01530100501	
Endura T-RS	1.5	55	Vac	short	KTURS01505501471	RIUS005504201671	DRUF055049030201	TAUF01530100551	
Endura T-RS	2.5	60	Vac	short	KTURS02506001471	RIUS006004501671	DRUF060054040201	TAUF02540100601	
Endura T-RS	2.5	65	Vac	short	KTURS02506501471	RIUS006505501671	DRUF065059040201	TAUF02540100651	
Endura T-RS	2.5	70	Vac	short	KTURS02507001471	RIUS007005501671	DRUF070064040201	TAUF02540100701	
Endura T-RS	3.2	75	Vac	short	KTURS03207501471	RIUS007505501671	DRUF075069040201	TAUF03246100751	
Endura T-RS	3.2	80	Vac	short	KTURS03208001471	RIUS008005501671	DRUF080074040201	TAUF03246100801	
Endura T-RS	3.2	85	Vac	short	KTURS03208501471	RIUS008506501671	DRUF085079040201	TAUF03246100851	
Endura T-RS	3.2	90	Vac	short	KTURS03209001471	RIUS009006501671	DRUF090084040201	TAUF03246100901	
Endura T-RS	4.0	95	Vac	short	KTURS04009501471	RIUS009506501671	DRUF095089050201	TAUF04065100951	
Endura T-RS	4.0	100	Vac	short	KTURS04010001471	RIUS010006501671	DRUF100092050201	TAUF04065101001	

DIMENSION

TYPE	PLUNGER L	PLUNGER T x a	PLUNGER M x B	PLUNGER Lt (Tube) -2mm	PLUNGER Qt Tube)	RING	SPRING BUSH	HOLDER	SYSTEM LENGTH L2	SYSTEM LENGTH total
Endura T-RS	63			79	10	Ø50/41,5 x 16	Ø50/44 x 30	Ø49 x 81	87.00	90
Endura T-RS	63			79	10	Ø55/46,5 x 16	Ø55/49 x 30	Ø54 x 81	87.00	90
Endura T-RS	74			88	10	Ø60/51 x 17	Ø60/54 x 40	Ø58 x 91	98.00	101
Endura T-RS	74			88	10	Ø65/56 x 17	Ø65/59 x 40	Ø63 x 91	98.00	101
Endura T-RS	74			88	10	Ø70/60 x 17	Ø70/64 x 40	Ø68 x 91	98.00	101
Endura T-RS	85			102	12	Ø75/64 x 17,5	Ø75/69 x 40	Ø73 x 105	113.00	117
Endura T-RS	85			102	12	Ø80/69 x 17,5	Ø80/74 x 40	Ø78 x 105	113.00	117
Endura T-RS	85			102	12	Ø85/74 x 17,5	Ø85/79 x 40	Ø83 x 105	113.00	117
Endura T-RS	85			102	12	Ø90/77 x 18,5	Ø90/84 x 40	Ø88 x 105	113.00	117
Endura T-RS	97			112	16	Ø95/82 x 18,5	Ø95/89 x 50	Ø93 x 115	125.00	129
Endura T-RS	97			112	16	Ø100/87 x 20	Ø100/92 x 50	Ø98 x 115	125.00	129



HTS Technology Group

Litostrojska cesta 60, SI-1000 Ljubljana, Slovenia
Phone: +386 1 5000 114
E-mail: sales@htsgroup.com

HTS SALES AND TECHNICAL SUPPORT NETWORK

SLOVENIA

HTS IC d.o.o.
Litostrojska ulica 60
SI-1000 Ljubljana
Slovenia
Phone: +386 1 5 000 114
E-mail: sales@htsgroup.com

GERMANY

HTS MWT GmbH
Max-von-Eyth-Straße 7
DE-86899 Landsberg/Lech
Germany
Phone: +49 81 91 94 77 214
E-mail: office.mwt@htsgroup.com

AUSTRIA

HTS IC GmbH
Heinrich Bablik-Straße 17
AT-1100 Wien
Austria
Phone: +43 1 60030 2911
E-mail: office.austria@htsgroup.com

FRANCE

HTS Technology France
Lyon Plaza Part Dieu 93 rue de la Villette
FR-69003 Lyon
France
Phone: +33 787 15 83 74
E-mail: jonathan.labarre@htsgroup.com

CZECH REPUBLIC

HTS IC s.r.o.
Viktora Huga 377/4
CZ-15000 Praha 5
Czech republic
Phone: +420 720 532 147
E-mail: office.cz@hts-ic.com

SPAIN

ALROTEC TECHNOLOGY, SL
Pol. Ind. de Constantí. Avgda.
de Les Punes Nav 5
E-43120 Constantí
Spain
Phone: +34 977 525 561
E-mail: alrotec@alro-tec.com

ITALY

Sidertoce S.p.A.
Via XX Settembre, 198
28883 Gravellona Toce (VB)
Italy
Phone: +39 0323 865208
E-mail: info@sidertoce.com

USA

HTS International Corporation
123 Center Park Dr. Ste 233
Knoxville, 37922
USA
Phone: +1 865 410 8880
E-mail: info@htsintl.com